

COPYRIGHT: ALL RIGHTS RESERVED. REPRODUCTION IN WHOLE OR IN PART IS PROHIBITED. THIS DRAWING IS THE PROPERTY OF BSA ENGINEERING CONSULTANTS INC. AND CANNOT BE USED IN ANY WAY WITHOUT WRITTEN AUTHORIZATION FROM BSA ENGINEERING CONSULTANTS INC.

| ISSUES                     |              |
|----------------------------|--------------|
| DESCRIPTION                | DATE         |
| ISSUED FOR COORDINATION    | SEP 07, 2018 |
| ISSUED FOR BUILDING PERMIT | SEP 26, 2018 |
|                            |              |
|                            |              |

THESE DRAWINGS ARE FOR THE PURPOSES SPECIFICALLY IDENTIFIED IN THE REVISION AND ISSUE COLUMNS. THE DRAWINGS ARE NOT FOR PRICING OR FOR CONSTRUCTION UNLESS INDICATED AS SUCH.



**BSA**  
Engineering  
Consultants Inc.  
(Mechanical Engineers)

115 – 14914, 104 Avenue,  
Surrey, B.C. V3R 1M7  
(p): (604) 589-8879  
(e): [bso@bsaengineering.co](mailto:bso@bsaengineering.co)  
(w): [www.BSAengineering.co](http://www.BSAengineering.co)

Sec

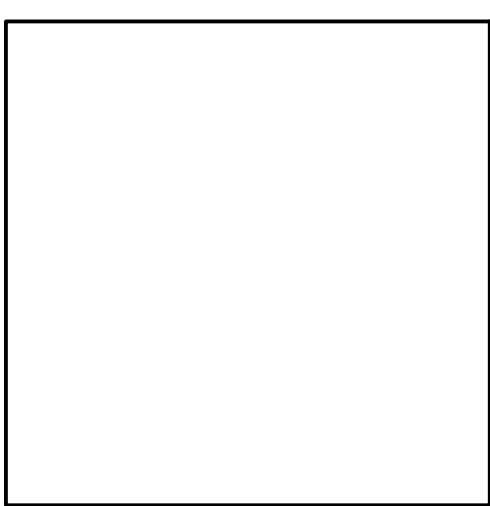

Project

# RESTAURANT PROPOSED TENANT IMPROVEMENT

2728 O'HARA LANE  
SURREY, BC

Sheet Title:

UPPER FLOOR  
HVAC

|               |             |
|---------------|-------------|
| Date:         | August 2018 |
| Scale:        | As Noted    |
| Project No. : | 1160        |

Drawing No.

## HVAC DESIGN NOTES

- 1 PROVIDE NEW 3" CLEARANCE REDUCTION BAFFLE BEHIND THE HOOD TO THE FLOOR. EXTEND THE BAFFLE 18" ABOVE THE HOOD AND 18" BEYOND THE HOOD. THE REDUCTION BAFFLE IS TO BE INSTALLED LESS 18" FROM COMBUSTIBLE CONSTRUCTION.
- 2 EXISTING BLACK IRON GREASE DUCT AND CLEARANCE REDUCTION BAFFLE. EXTEND BAFFLE TO 18" MIN. BELOW SLOPED ROOF AS REQUIRED.
- 3 EXISTING HOOD AND EXHAUST DUCTING TO REMAIN.
- 4
- 5 NEW MAKE UP AIR UNIT ON ROOF.
- 6 SUPPLY AIR DUCT RUNS 14" ABOVE FLAT ROOF AND ENTERS ATTIC FROM THE SIDE. SEE SECTION 98.
- 7 OUTLINES OF THE FLAT ROOF ABOVE.
- 8 DUCT IN ATTIC SPACE.
- 9 EXISTING BLACK RON STEEL WELDED GREASE DUCT MAINTRA AND 3" TO LIMITED COMBUSTIBLE MATERIALS.
- 10 PROVIDE MORTA FOR A HOLE IN DOUBLE WALL S.S. TERMINATED ABOVE ROOF AS PER MANUFACTURE RECOMMENDATIONS.

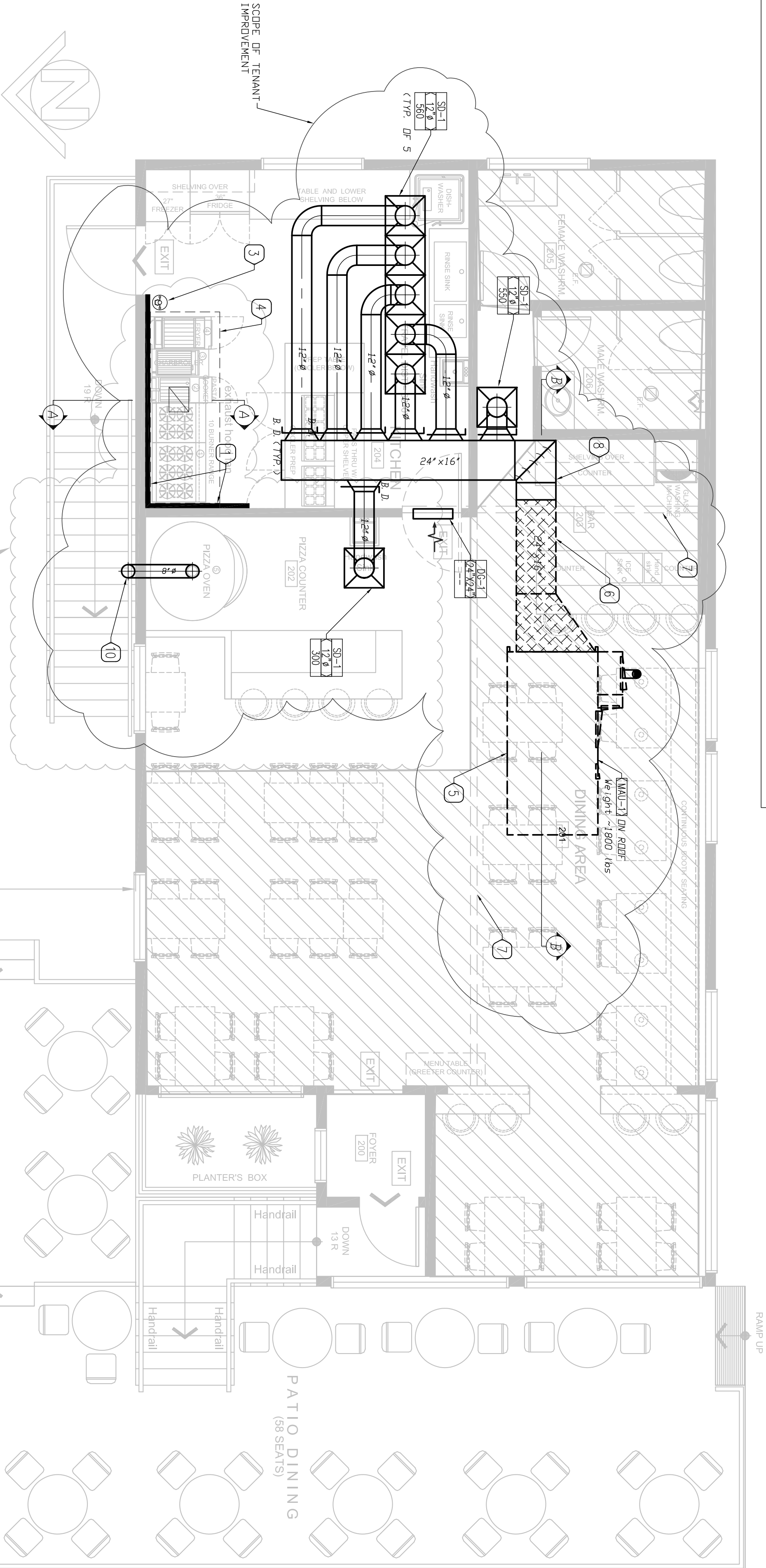
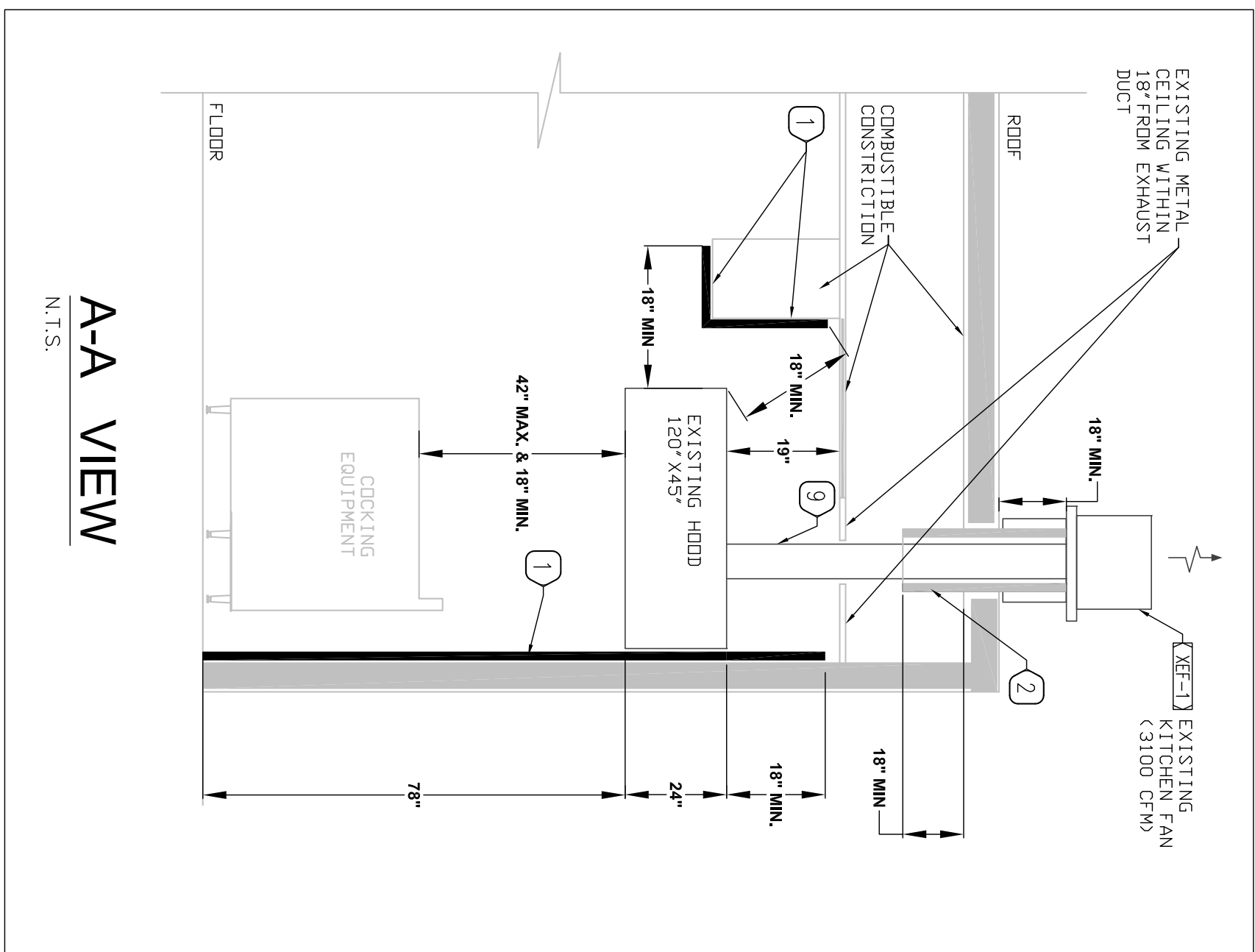
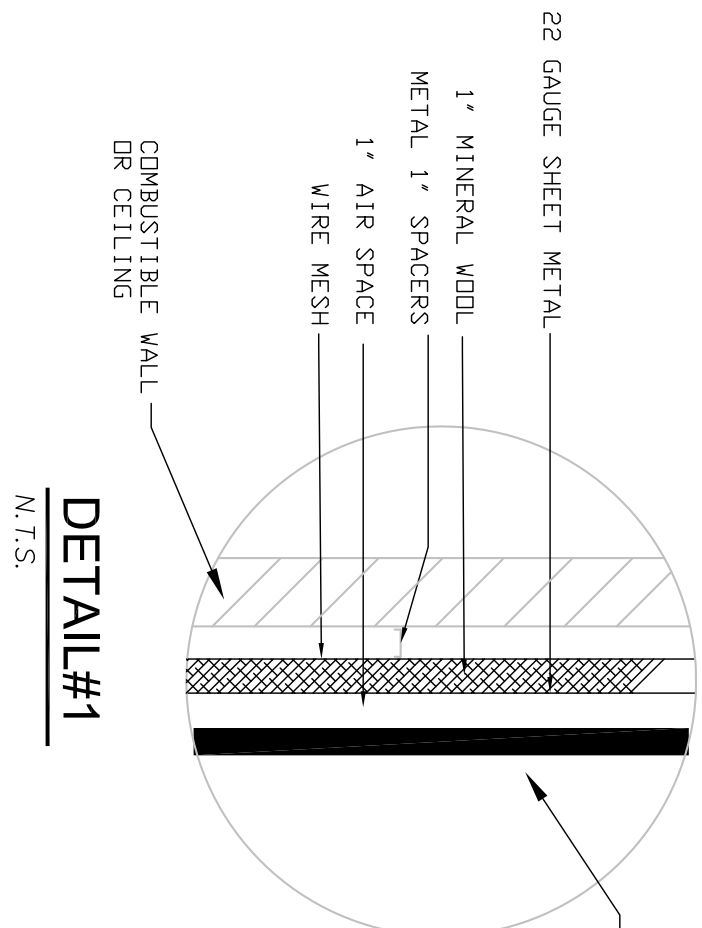

|   |                 |                   | GAS REQUIREMENT |
|---|-----------------|-------------------|-----------------|
|   | APPLIANCES      | MODEL NUMBER      |                 |
| 1 | 10 BURNER RANGE | AMERICAN RANGE    | 390 MBH         |
| 2 | PASTA COOKER    | MODEL:AVR-10      |                 |
|   |                 | MODEL:SPSG14      | 60 MBH          |
| 3 | CHARBROILER     | STAR-400          |                 |
|   |                 | MODEL:AVO15CBF    | 40 MBH          |
| 4 | FRYER           | PITCO             |                 |
|   |                 | MODEL:AS5H455.5SR | 100 MBH         |
| 5 | PITZA OVEN      | NECOPOLITAN       |                 |
|   |                 | MODEL:AVP110      | 84 MBH          |

1. ADD PIZZA OVEN AND COUNTER

## HVAC FLOOR PLAN

SCALE: 1/4" = 1'-0"

| ENGINEERED INDIRECT AIR MAKE UP AIR UNIT SCHEDULE |          |              |          |              |  |                         |                     |                  |                  |
|---|----------|--------------|----------|--------------|--|-------------------------|---------------------|------------------|------------------|
| UNIT #  | TAG      | MANUFACTURER | MODEL #  | HEATING TYPE | EXCH. COEFF. (BTU/HR/FT <sup>2</sup> ) | COOLING CAPACITY (TONS) | SUPPLY ESP (FAN HP) | EXCH. CAP. (GPM) | EXCH. CAP. (GPM) |
| 204-1   | ENG. AIR | DAVID        | 300-4894 | 55 °F        | 243 Btu/hr/ft <sup>2</sup>             | 3.60 (GPM) 1.57         | 2 HP                | 208              | 1                |
|   |          |              |          |              |  | 60 (GPM) 1.80           |                     | 162              | 1.80             |
|   |          |              |          |              |  | 123.5 (GPM) 6.78        |                     |                  |                  |

1. CABLE APPROVAL
2. SETTING RESTRAIN
3. HOISTING DISCHARGE - BARKER CONFIGURATION AS PER DRAWINGS
4. SUPPLY AIR TEMPERATURE CONTROLLER BY SPACES THERMOSTAT
5. FLEXIBLE DUCT CONNECTION
6. VIBRATION ISOLATORS
7. WALL-1 IP AIR SHAFT BE DOUBLE INTERLOCKED WITH KITCHEN WFE-1 AND FIRE SUPPRESSION SYSTEM SEE CONTROL SPEC. FOR MORE INFORMATION
8. DISCONNECT SWITCH BY DIVISION 16.

### AIR OUTLETS SPECIFICATIONS

|       |  |
|-------|--|
| SD-1: | CAPTIVE AIR PERFORATED DROP-IN STEEL SUPPLY AIR GRILLE |
|       | MODEL D1-PSP 24" X24" OR EQUAL                         |
| DG-1: | E.H.PRICE ATGI SERIES                                  |

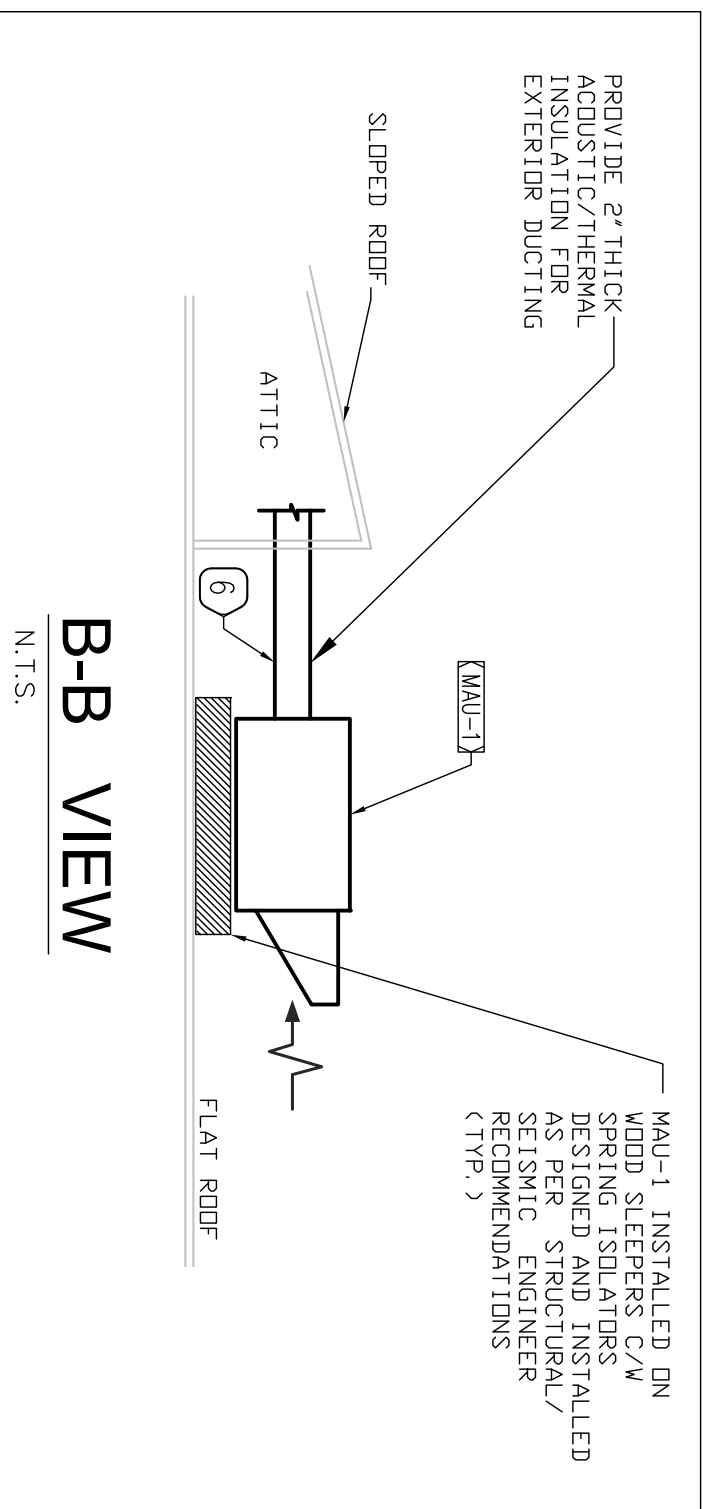

## AERIAL VIEW OF ROOF PLAN

SCALE: N.T.S.







